

# EPPING - R89

2 BED, 1 BATH

GrannyFlat  
solutions

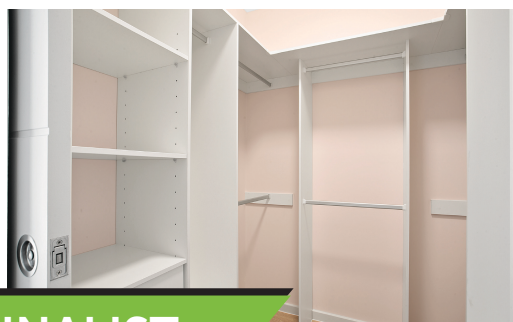

## 2020 MBA AWARD FINALIST

- 60m<sup>2</sup> custom designed Granny Flat
- 18m<sup>2</sup> tiled Porch
- Bedroom with Walk-in-robe
- Timber cladding
- Colorbond Roof
- Vinyl floor planks in Kitchen & Living
- Carpet in Bedrooms
- LED downlights throughout
- Air conditioner
- Ceiling fans with lights
- Window roller blinds
- 20mm stone benchtop
- Polyurethane cabinetry
- Herringbone splashback tiles
- Induction cooktop & Westinghouse appliances
- Externally ducted rangehood
- Dishwasher
- Semi-frameless shower screen
- Subway-tiled Bathroom wall
- Laundry tub & vanity combo
- Black Phenonix accessories
- Ceiling arm & shower rose

# EPPING - R89

2 BED, 1 BATH

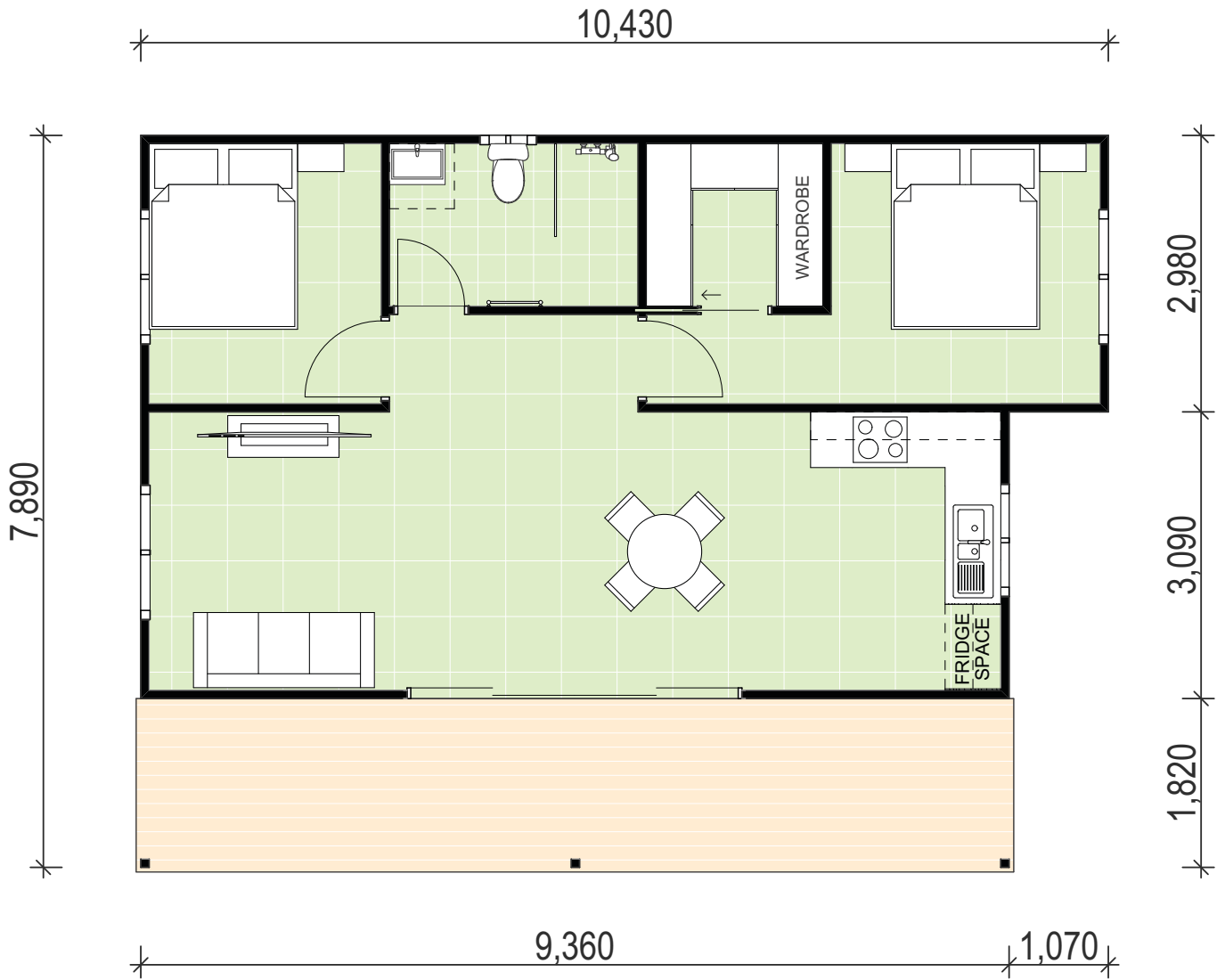

See more of this project and others on our website!



The Only Multi-Award Winning Builders— Build with the Best

(02) 9481 7443  
info@GrannyFlatSolutions.com.au  
www.GrannyFlatSolutions.com.au